

Additional applications for the BOLT ON TURBO SYSTEM
has been confirmed for the R35 GT-R



[Click here for further information on the BOLT ON TURBO SYSTEM](#)



Product Characteristics

- Bolt on turbo chargers for the R35 GT-R can be swapped with the stock system to achieve 750PS.
The highly reliable IHI turbo chargers have been utilized and designed to be compatible with the stock catalytic converter.
- By utilizing a turn buckle actuator, the initial boost pressure can be adjusted.
- The product is directly bolt on for 2020 models equipped with segmented exhaust manifolds.
- Machined out of aluminum the compressor wheel is larger than stock but lighter by 1.8g.
- Compared to the previous model, the turbine wheel and wings have been redesigned to significantly improve response at low rpm.
 - ※ The product only includes the turbo chargers.
 - ※ Please be aware that by installing this product, Nissan`s warranty will be void.
 - ※ To install this product on vehicles made before 2019/06, the exhaust manifold and heat shield from models made after 2019/06 must be purchased and installed.
 - ※ In order to install this product, the engine must be removed.
Please have a professional with expertise in the field install the product for you.
We will not be able to provide you with installation support.
 - ※ The injector and fuel pump must be changed to a larger type since the stock capacity will be insufficient.
ECU Settings such as boost pressure, fuel, ignition timing must be recalibrated.
The product does not come with injectors, fuel pump, or ECU settings.
Please have a professional install the necessary parts and adjust the settings.
 - ※ We will not take any responsibility for any damages that may occur to the vehicle after installing this product.

Information on Compatible Vehicles							
(Vehicle)	(Model Year)	(Model)	(E/G Model)	(Code No.)	(MSRP w/tax)	(MSRP)	(JAN Code)
NISSAN							
GT-R	2007/12-	R35	VR38DETT	10206	¥1,100,000	¥1,000,000	4959094102069

■ 4862GTR-750R Turbo

Turbo Specification							
Model	Capability	Comp Wheel			Turbin Wheel		
		trim	In Dia(mm)	Ex Dia(mm)	trim	In Dia(mm)	Ex Dia(mm)
2020 Stock	-	60.1	43.4	56.0	57.2	53.0	40.1
4862GTR-750R	750 PS	60.7	48.3	62.0	77.6	53.0	46.7



■ Power Graph

Increase in Maximum Output by 96.4PS, Increase in Maximum Torque by 229.2Nm

Engine : Stock Air Cleaner and Exhaust System

Injector : 700cc

Fuel Pump : 295L/h×2

Boost : 1.2×100kPa

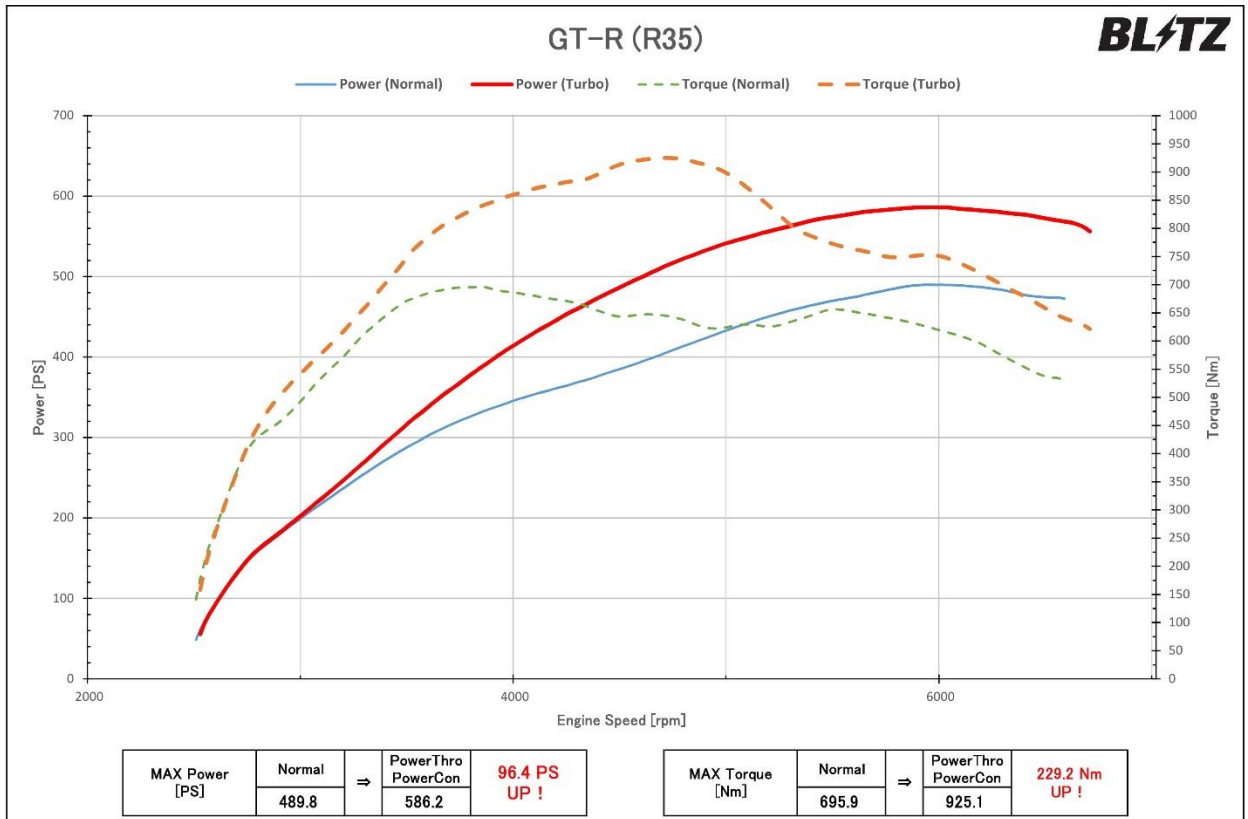

※グラフ、データは弊社シャーンダイナモでの計測事例です。車両ならびに装着部品、燃料などにより個体差があります。

■ Necessary Replacement Parts

- When removing the engine and stock turbo charger, please prepare new parts that are designated as non-reusable.
- Even if the part may be reusable, it is best to install new parts since they may be worn or fatigued.
- The parts shown in the list below are just for reference.
- Other parts may be necessary when removing the engine or if other work is being done.

※ The parts below are not included in the product. The price shown below are from February 2022.

Stock Part Number	Product Name	MSRP (without tax)	Amount
A4D01-JF00A	Gasket Kit, Turbo Charger	¥5,200	1
14036-JF04A	Gasket, Exhaust Manifold ※1	¥1,740	2
14094-JG30A	Nut, Exhaust Manifold ※1	¥140	12
14064-31U0C	Stud, Exhaust Manifold ※1	¥290	12
14069-4P100	Bolt, Exhaust Manifold	¥380	2
14416-5X00A	Stud, Exhaust Manifold – Turbo (6)	¥260	16
	Stud Bolt, Outlet Pipe (10)		
14094-4P100	Nut, Exhaust Manifold - Turbo (6)	¥140	16
	Nut, Turbo - Outlet Pipe (10)		
14465-4P210	Gasket, Inlet Pipe	¥380	2
14069-JD00A	Bolt, Exhaust Manifold Cover (8)	¥210	20
	Bolt, Heat Insulator Bank 1 (5)		
	Bolt, Heat Insulator Bank 2 (7)		
01225-00062	Nut, Outlet Pipe Stay	¥120	2
20692-24U0A	Gasket, Outlet - Sub Muffler	¥920	2
20602-41G0A	Nut, Outlet - Sub Muffler	¥180	4
20692-JF00A	Gasket, Sub Muffler - Muffler	¥800	1
08918-3401A	Nut, Sub Muffler - Muffler	¥120	2
37120-JD00B	Bolt, Main Propeller Shaft Front	¥210	4
37171-7500A	Nut, Main Propeller Shaft Front	¥210	4
37120-JF00A	Bolt, Main Propeller Shaft Rear	¥180	6
37121-0E605	Nut, Main Propeller Shaft Rear	¥380	3
37120-CG10A	Bolt, Front Propeller Shaft Front	¥210	4
37120-JF01A	Bolt, Front Propeller Shaft Rear	¥210	4
01223-00041	Nut, Front Propeller Shaft Rear	¥210	4
11298-4M418	Bolt, Front Propeller Shaft Stay	¥290	7

※1. Parts necessary for models made after 2019/06 when removing the exhaust manifold.

- Coolant : Roughly 11.3L
- Engine Oil : Oil Change Only 4.5L , When Changing the Oil Element 5.0L

■ Models made before 2019/06 will require the following parts as well as the parts from the previous page.
Please prepare the parts before hand for proper installation.

※ The parts below are not includes in the product. The price shown below are from February 2022.

Number	Stock Part Number	Product Name	MSRP (Without Tax)	Amount
①	14004-6HT0A	Manifold, Exhaust Bank 1	¥51,500	1
②	14006-6HT0A	Manifold, Exhaust Bank 2	¥51,500	1
③	16590-6HT0A	Cover, Exhaust Manifold Bank 1	¥5,740	1
④	16590-6HT0B	Cover, Exhaust Manifold Bank 2	¥5,740	1
⑤	14450-6HT0A	Heat Insulator, Turbo Housing Bank 1	¥3,370	1
⑥	14450-6HT0B	Heat Insulator, Turbo Housing Bank 2	¥3,370	1

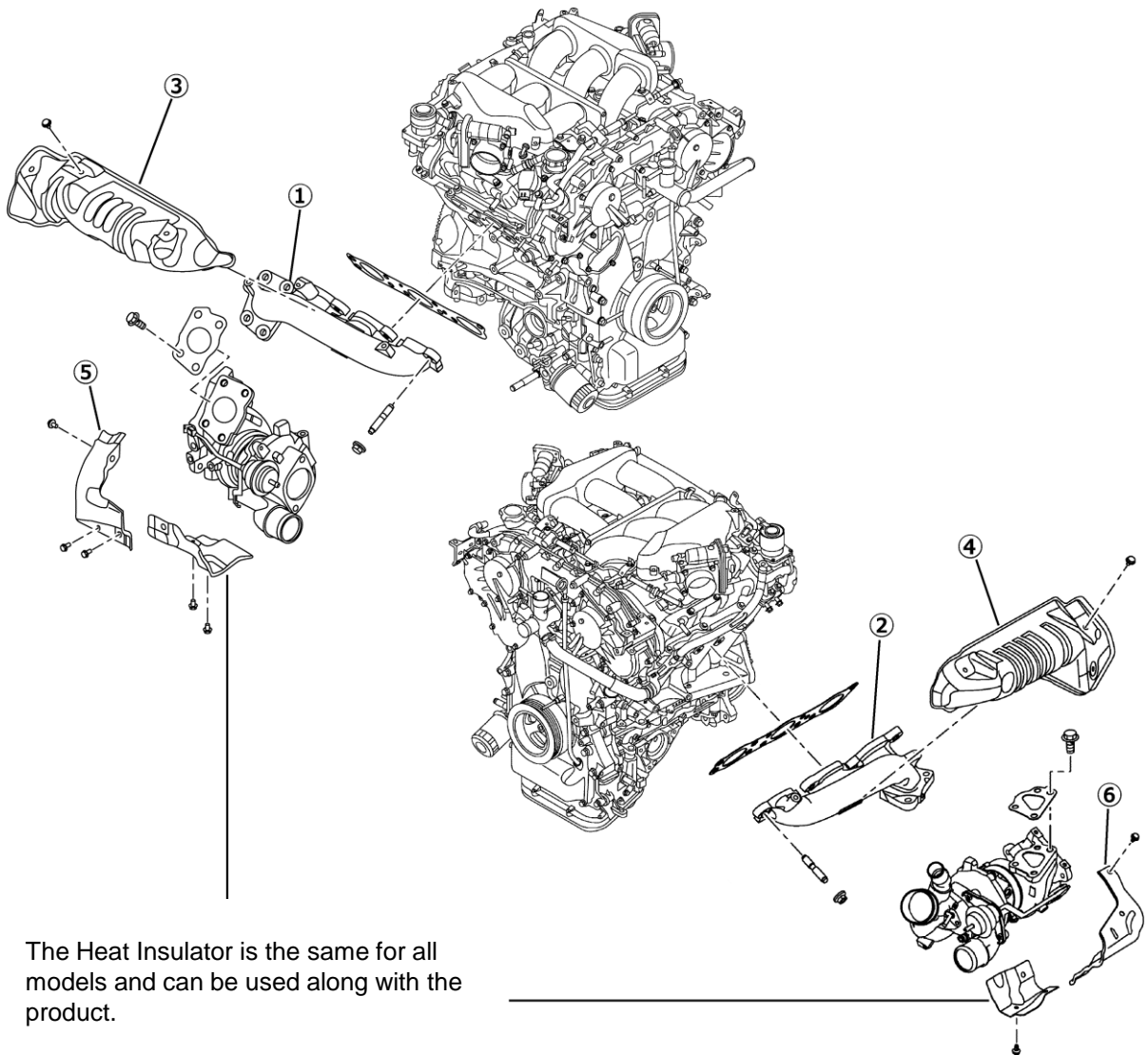

The Heat Insulator is the same for all models and can be used along with the product.